

**SHIRE OF CUBALLING**  
**COUNCIL MEETING THURSDAY 17 MAY 2012**

**MINUTES**

**TABLE OF CONTENTS**

- 1. OPENING - ANNOUNCEMENT OF VISITORS**
- 2. ATTENDANCE, APOLOGIES, LEAVE OF ABSENCE**
- 3. PUBLIC QUESTION TIME**
- 4. STANDING ORDERS**
- 5. APPLICATIONS FOR LEAVE OF ABSENCE**
- 6. MINUTES**
- 7. PETITIONS, DEPUTATIONS, PRESENTATIONS & DECLARATIONS**
- 8. DISCLOSURES OF INTEREST**
- 9. REPORTS**
  - 9.1 FINANCE**
    - 9.1.9 List of Accounts Submitted for Council Approval*
    - 9.1.10 Statement of financial Activity*
  - 9.2 CEO REPORT**
    - 9.2.16 Option to purchase lot 1, Alton Street, Cuballing*
    - 9.2.17 Bauxite Resources Limited*
    - 9.2.18 Boundary Change – Wickepin Pingelly Road*
    - 9.2.19 Appointment of Dual Fire Control Officers*
    - 9.2.20 Representation Issues*
    - 9.2.21 WALGA Annual General Meeting 2012*
  - 9.3 WORKS**
    - 9.3.8 Works Managers Report*
    - 9.3.9 10 Year Road Program*
    - 9.3.10 Letter of Complaint*
  - 9.4 HEALTH & BUILDING REPORT**
    - 9.4.6 Popanyinning General Store – Application to add an alfresco & covering to existing approved fast food outlet*
    - 9.4.7 Outbuilding Proposal Lot 331 Carton Street, Cuballing*
- 10. ELECTED MEMBERS' MOTIONS OF WHICH PREVIOUS NOTICE HAS BEEN GIVEN**
- 11. OTHER URGENT BUSINESS**
- 12. NEXT MEETING**
- 13. CLOSURE OF MEETING**

1. **OPENING - ANNOUNCEMENT OF VISITORS**

Cr Tom Wittwer - President  
Cr Roger Newman - Deputy President  
Cr Tim Haslam  
Cr Chad Hawksley  
Cr Carol McDougall  
Cr Mark Conley  
Mrs Eva Haydon - Chief Executive Officer  
Mr Brian Harvison - Owner/Manager Cuballing Tavern

2. **ATTENDANCE, APOLOGIES, LEAVE OF ABSENCE**

Nil

3. **PUBLIC QUESTION TIME**

Mr Harvison spoke to Council regarding his intention to construct a railing along the front of the hotel.

4. **STANDING ORDERS**

**OFFICER RECOMMENDATION**

**That Standing Orders be suspended for the duration of the meeting to allow for greater debate on items.**

**Moved Cr R Newman**

**Seconded Cr C Hawksley**

5. **LEAVE OF ABSENCE:**

Nil

6. **MINUTES**

**6.1 CONFIRMATION OF 19 APRIL 2012 ORDINARY MEETING OF COUNCIL**

**OFFICER RECOMMENDATION**

**That the minutes (as circulated) of the ordinary meeting of the Shire of Cuballing held in the Council Chambers on 19 April 2012 be confirmed.**

**Moved: Cr Newman**

**Seconded: Cr McDougall**

***Carried 6/0***

**7. PETITIONS, DEPUTATIONS, PRESENTATIONS & DECLARATIONS**  
**8. DISCLOSURES OF INTEREST**

Councillors' and Employees' Disclosures of Interest.

**8.1 DISCLOSURE OF FINANCIAL INTEREST AND PROXIMITY INTEREST**

Members must disclose the nature of their interest in matters to be discussed at the meeting.

Employees must disclose the nature of their interest in reports or advice when giving the report or advice to the meeting.

**8.2 DISCLOSURE OF INTEREST AFFECTING IMPARTIALITY**

Members and staff must disclose their interest in matters to be discussed at the meeting in respect of which the Member or employee has given or will give advice.

## 9.1 REPORTS – FINANCE AND ADMINISTRATION

---

### 9.1.9 LIST OF ACCOUNTS SUBMITTED FOR COUNCIL APPROVAL AND PAYMENT – APRIL 2012

---

**Submission to:** Ordinary Meeting of Council  
**Location/Address:** Not applicable  
**Reporting Officer:** Nikole Brennan, Administration Officer  
**Enabling Legislation:** Local Government (Financial Management) Regulations 1996  
**Council Policy:** Register Delegated Authority  
**Budget Implications:** Nil  
**File Reference:** CMR 7  
**Voting Requirements:** Simple Majority

#### Background

Council is supplied with a list of payments for consideration.

#### Comment

A copy of the list of payments made from each of Council's bank accounts is attached to this item.

#### OFFICER RECOMMENDATION:

That Council:

Approve for payment the list of Creditors paid from the Municipal fund, as detailed below, totalling: \$215,393.10

Vouchers 14184-14186	\$1,515.30
Electronic Fund Transfers	\$213,677.80
Credit Card	\$3.33

#### Trust

Vouchers	\$0.00
Electronic Funds Transfers	\$200.00

Moved: Cr Newman

Seconded: Cr Conley

*Carried 6/0*

## Shire of Cuballing Cheque Detail

April 2012

Type	Num	Date	Name	Description	Original Amount
Bill Pmt -Cheque	Debit	02/04/2012	LGIS Insurance Broking	Insurance,CN0,CN1 and CN1557	-1,353.78
Bill Pmt -Cheque	Debit	02/04/2012	BUILDING COMMISSION, DEPT OF COMMERCE	Reconciliation March 12	-108.00
Bill Pmt -Cheque	Debit	05/04/2012	G.S. Hobbs Contracting	Storm Damage	-30,244.50
Bill Pmt -Cheque	Debit	05/04/2012	TELSTRA	Mobile Phone Charges	-392.94
Bill Pmt -Cheque	Debit	10/04/2012	Halanson Earthmoving	Drainage	-33,000.00
Bill Pmt -Cheque	Debit	10/04/2012	TELSTRA	Phone Charges	-90.75
Bill Pmt -Cheque	Debit	10/04/2012	R n R Contracting PTY LTD	Emulsion Sealing Work	-27,484.18
Bill Pmt -Cheque	Debit	10/04/2012	R n R Contracting PTY LTD	Bitumen Sealing Work	-37,621.76
Bill Pmt -Cheque	Debit	12/04/2012	TOWN OF NARROGIN	Annual contribution for Library Services	-3,300.00
Bill Pmt -Cheque	Debit	12/04/2012	Toll Ipec	Freight	-19.89
Bill Pmt -Cheque	Debit	12/04/2012	WATER CORPORATION	Water Charges	-843.30
Bill Pmt -Cheque	Debit	16/04/2012	Department of Transport	Licence	-24.05
Bill Pmt -Cheque	Debit	18/04/2012	Avon Waste	Bulk Bin Service & Rent	-521.97
Bill Pmt -Cheque	Debit	18/04/2012	Australian Communications & Media Authori	APPARATUS Licence Renewal Fees	-99.00
Bill Pmt -Cheque	Debit	18/04/2012	Auslec	Strobelight Beacon	-199.58
Bill Pmt -Cheque	Debit	18/04/2012	AIR LIQUIDE WA PTY LTD	Cylinder Fee G and E size	-96.71
Bill Pmt -Cheque	Debit	18/04/2012	BEAUREPARES	Tyre Repair	-120.00
Bill Pmt -Cheque	Debit	18/04/2012	CORPORATE EXPRESS	Office Stationary	-69.94
Bill Pmt -Cheque	Debit	18/04/2012	CANNON HYGIENE AUSTRALIA PTY LTD	Bi Annual charge for Sanitary Unit	-352.37
Bill Pmt -Cheque	Debit	18/04/2012	CUBY ROADHOUSE	March Charges	-882.17
Bill Pmt -Cheque	Debit	18/04/2012	DEWS MINI EXCAVATIONS	Clean out culverts	-921.25
Bill Pmt -Cheque	Debit	18/04/2012	DEWS MINI EXCAVATIONS	Excavate tree and stumps in Cuballing Townsite	-4,059.00
Bill Pmt -Cheque	Debit	18/04/2012	EDWARDS MOTORS PTY LTD	Filter Kits	-137.65
Bill Pmt -Cheque	Debit	18/04/2012	FARMWORKS RURALCO	Antex Granules 500grams	-19.80
Bill Pmt -Cheque	Debit	18/04/2012	Fuji Xerox	Carbon paper	-205.43
Bill Pmt -Cheque	Debit	18/04/2012	Fuji Xerox	March Photocopy	-605.98
Bill Pmt -Cheque	Debit	18/04/2012	Greenline Ag	Filter	-41.90
Bill Pmt -Cheque	Debit	18/04/2012	GREAT SOUTHERN FUEL SUPPLIES	March 12	-12,609.81
Bill Pmt -Cheque	Debit	20/04/2012	TELSTRA	March Phone Charges	-467.48
Bill Pmt -Cheque	Debit	20/04/2012	Southern Lock & Security	Master Keying	-352.00

## Shire of Cuballing Cheque Detail

		April 2012			
Bill Pmt -Cheque	Debit	26/04/2012	Synergy	Streetlight Charges	-516.65
Bill Pmt -Cheque	Debit	26/04/2012	STEWART & HEATON CLOTHING CO. P/L	Fire Fighting Clothes	-308.13
Bill Pmt -Cheque	Debit	26/04/2012	Road Signs Australia	Signs	-321.20
Bill Pmt -Cheque	Debit	26/04/2012	Reckon Limited	Quickbooks Premier 2012/13 Direct Subscriber	-680.00
Bill Pmt -Cheque	Debit	26/04/2012	Toll Ipec	Freight	-8.78
Bill Pmt -Cheque	Debit	26/04/2012	Ballards Of Narrogin	Gas	-120.00
Bill Pmt -Cheque	Debit	26/04/2012	Conplant Australia	Filters	-137.53
Bill Pmt -Cheque	Debit	26/04/2012	CLAW ENVIRONMENTAL	Steel and Plastic Drums (drummaster)	-775.61
Bill Pmt -Cheque	Debit	26/04/2012	CUBALLING CONCRETE and CONTRACTORS	Liners	-522.50
Bill Pmt -Cheque	Debit	26/04/2012	EDWARDS MOTORS PTY LTD	Guage	-93.55
Bill Pmt -Cheque	Debit	26/04/2012	Great Southern Waste Disposal	Management of Shire Tip	-2,858.21
Bill Pmt -Cheque	Debit	26/04/2012	JR & A HERSEY P/L	Guide Posts	-3,300.00
Bill Pmt -Cheque	Debit	26/04/2012	Malatesta Road Paving & Hotmix	7mm Premix	-1,900.00
Bill Pmt -Cheque	Debit	26/04/2012	METROCOUNT	Battery Pack	-646.80
Bill Pmt -Cheque	Debit	26/04/2012	MCDUGALL WELDMENTS	Parts and Labour	-720.42
Bill Pmt -Cheque	Debit	26/04/2012	MAKIT NARROGIN HARDWARE	Parts	-79.85
Bill Pmt -Cheque	Debit	26/04/2012	MCDUGALL WELDMENTS	Sandblast and Undercoat Truck Trays and sides	-1,724.42
Bill Pmt -Cheque	Debit	26/04/2012	J & W Zarb Car Craft	Clean tar from Tyres (Geire Kami)	-264.00
Bill Pmt -Cheque	Debit	27/04/2012	bims earthmoving	Tree Clean up Williams Rd	-19,360.00
Bill Pmt -Cheque	Debit	27/04/2012	bims earthmoving	Tree Clean up Williams Rd	-19,010.75
Bill Pmt -Cheque	Debit	27/04/2012	Narrogin Pumps Sales & Service	Hose and Various fittings	-76.34
Bill Pmt -Cheque	Debit	27/04/2012	NARROGIN BEARING SERVICE	Parts	-85.78
Bill Pmt -Cheque	Debit	27/04/2012	NARROGIN PACKAGING	Toilet rolls and bin liners	-182.30
Bill Pmt -Cheque	Debit	27/04/2012	NARROGIN AUTO ELECTRICS	Globes	-159.00
Bill Pmt -Cheque	Debit	27/04/2012	Narrogin Technology Solutions	Pc for Front Counter	-1,749.00
Bill Pmt -Cheque	Debit	27/04/2012	Narrogin Technology Solutions	Repair Computer	-80.00
Bill Pmt -Cheque	Debit	27/04/2012	NARROGIN HIRE SERVICE AND RETICULATION	Parts	-100.70
Bill Pmt -Cheque	Debit	27/04/2012	NARROGIN AGRICULTURAL REPAIRS	Parts	-268.00
Bill Pmt -Cheque	Debit	27/04/2012	Narrogin Pumps Sales & Service	Parts	-48.73
Bill Pmt -Cheque	Debit	27/04/2012	Narrogin Pumps Sales & Service	Parts and Fittings	-1,334.36
Bill Pmt -Cheque	Debit	02/04/2012	SHIRE OF CUBALLING.	Photocopy cost for Country Festival	-910.00
Bill Pmt -Cheque	14184	02/04/2012	Building & Construction Industry Training	March reconciliation 12	-176.80
Bill Pmt -Cheque	14185	05/04/2012	CASH.	Petty Cash April 12	-428.50
Bill Pmt -Cheque	14186				

# Shire of Cuballing Cheque Detail

Trust	Debit	2/04/2012	Leontie Gould	Bond Repayment Cuby Rec Centre	-200.00
				Municipal (Direct Debit)	-213,677.80
				Municipal (Cheque)	-1,515.30
				Credit Card	-3.33
				Trust	-200
				<b>TOTAL</b>	<b>-215,393.10</b>

### 9.1.10 STATEMENT OF FINANCIAL ACTIVITY

---

**Submission to:** Ordinary Meeting of Council  
**Location/Address:** Not applicable  
**Reporting Officer:** Clare Thomson  
**Enabling Legislation:** Local Government (Financial Management) Regulations 1996  
**Council Policy:** Nil  
**Budget Implications:** Nil  
**File Reference:** CMR 7  
**Voting Requirements:** Simple majority

#### **Background**

Local Government (Financial Management) Regulations 1996, section 34, provides for monthly financial reporting requirements for local government.

#### **Comment**

A Statement of Financial Activity has been prepared for period ending 30 April 2012 in accordance with the abovementioned legislation and circulated with the Council Meeting Agenda.

#### **OFFICER RECOMMENDATION:**

**That the Statement of Financial Activity, as circulated, for the Shire of Cuballing for period ending 30 April 2012, be received.**

**Moved: Cr McDougall**

**Seconded: Cr Haslam**

***Carried: 6/0***



Shire of Cuballing  
Bank Reconciliation as at 30 April 2012

	Municipal Fund	Trust Fund	Reserve Accts
Opening balance	567,778.85	57,655.07	558,742.23
Income	200,886.18		
Add interest	2,024.07		
Expenditure	- 265,999.10		
<b>Closing balance</b>	<b>504,690.00</b>	<b>57,655.07</b>	<b>558,742.23</b>
Bank account	202,930.90	57,655.07	2,903.89
Investments	300,000.00		555,838.34
Plus O/S deposits	1,759.10		
Less O/S cheques			
<b>Closing balance</b>	<b>504,690.00</b>	<b>57,655.07</b>	<b>558,742.23</b>

Investments  
as at 30 April 2012

Account Number	Maturity Date	Interest Rate	Fund/Account	
			Municipal	Trust
34455506	Cash Deposit	4.00%	-	555,838.34
34681402	Cash Deposit	4.00%	300,000.00	
<b>Total</b>			<b>300,000.00</b>	<b>555,838.34</b>

Shire of Cuballing  
Notes on financial reports for April 2012

**General Purpose Funding**

Rates

At present an amount of \$743,862 has been raised in rates with a discount of \$45,939. Debtors at the end of April are \$36,254.

Grants

Grant funding of \$655,327 from various funding sources have been received.

**Governance**

Conferences

This is the cost of councillors attend local government week.

Subscriptions

This includes subscriptions to WALGA of \$17,072, Time base of \$218 and Central Country Zone of \$2,800.

**Law Order Public Safety**

Grant and Subsidies

All quarterly grant payments have been received from FESA together with an administration fee of \$4,000. We have also had to account for the sale of the Popo land cruiser for no monetary consideration. It is just a book entry of \$8,662 being received and the same amount has been expensed under other goods and services.

Council has also received a grant of \$319,682 for the purchase of new fire vehicle located at Popanyinning. This item was not budgeted for the 2011/12 financial year.

Animal Control

Council has received \$2,143 in dog regns compared to a budgeted figure of \$900. This year has seen a marked increased in the number of dogs being registered in the Shire.

**Housing**

Loss on sale of assets

Following an investigation into Councils' asset register it was discovered that three blocks were still showing on the register even though they had been sold in 1998. This has resulted in a loss of \$9,750.

**Recreation and Culture**

Grants and contributions

\$15,000 was received from the Narrogin Pony Club as a contribution to the Equestrian Centre. \$166,379 was received from Department of Sport and Recreation and \$30,000 from the Narrogin Equestrian Centre.

Popanyinning Hall

Due to repairs carried out to the roof, it is anticipated that expenditure will exceed the budget figure. At this stage the estimated cost to repairs will be approximately \$25,000. It is hoped that this will not adversely affect the budget result with savings being made in other areas.

**Shire of Cuballing**  
**Notes on financial reports for April 2012**

**Transport**

Grant Funding

Grant funding of \$1,246,022 has been received from various funding bodies. This includes \$564,504 received for storm damage.

Depot Maintenance

This includes restricted keys and locks to the total of \$1,780, constructing a concrete bunker at the depot at a cost of \$4,485.

Grading Maintenance

This is the grading carried out on various roads throughout the Shire.

General Maintenance

This includes an amount of \$586,503 paid to contractors for cleaning up after the storm that occurred in January 2011. A proportion of these costs will be reimbursed to the Shire.

**Other Property and Services**

Private Works

To date an amount of \$49,486 has been received from private works. The main income items are plant hire charges of \$19,618 and sand/gravel sales of \$26,530

Parts and repairs

This includes unforeseen expenditure on parts for the roller of \$9,204, and grader blades of \$9,642. It is anticipated that will exceed budget figure for the year, and I have revised this amount from \$72,000 to \$102,000 for the year.

**SHIRE OF CUBALLING**  
**MONTHLY STATEMENT OF FINANCIAL ACTIVITY**  
**FOR THE PERIOD 1 JULY 2011 TO 30 APRIL 2012**

**TABLE OF CONTENTS**

Statement of Financial Activity	2
Notes to and Forming Part of the Statement	3 to 15

**SHIRE OF CUBALLING**  
**MONTHLY STATEMENT OF FINANCIAL ACTIVITY**  
**FOR THE PERIOD 1 JULY 2011 TO 30 APRIL 2012**

**TABLE OF CONTENTS**

Statement of Financial Activity	2
Notes to and Forming Part of the Statement	3 to 15

**SHIRE OF CUBALLING**  
**STATEMENT OF FINANCIAL ACTIVITY**  
**FOR THE PERIOD 1 JULY 2011 TO 30 APRIL 2012**

	NOTE	30 April 2012 Actual \$	30 April 2012 Y-T-D Budget \$	2011/2012 Budget \$	Variances Budget to Actual Y-T-D %
<b><u>Operating</u></b>					
<b>Revenues/Sources</b>					
Governance		14,061	13,900	18,400	(1.16%)
General Purpose Funding		689,368	688,500	468,103	(0.13%)
Law, Order, Public Safety		360,797	33,400	23,720	(980.23%)
Health		1,493	1,400	1,364	(6.64%)
Education and Welfare		-	-	-	0.00%
Housing		-	-	-	0.00%
Community Amenities		3,811	3,600	1,500	(5.86%)
Recreation and Culture		214,287	212,200	787,659	(0.98%)
Transport		1,423,442	1,420,000	739,622	(0.24%)
Economic Services		10,551	9,550	21,045	(10.48%)
Other Property and Services		106,462	105,000	63,000	(1.39%)
		<u>2,824,272</u>	<u>2,487,550</u>	<u>2,124,413</u>	
<b>(Expenses)/(Applications)</b>					
Governance		(370,850)	(365,000)	(148,098)	(1.60%)
General Purpose Funding		(46,941)	(46,000)	(96,986)	
Law, Order, Public Safety		(63,503)	(62,500)	(123,803)	(1.60%)
Health		(11,049)	(11,000)	(31,127)	(0.45%)
Education and Welfare		(350)	(400)	(9,139)	
Housing		(21,608)	(20,500)	(16,933)	(5.40%)
Community Amenities		(76,236)	(76,000)	(160,713)	(0.31%)
Recreation & Culture		(131,698)	(129,000)	(192,465)	(2.09%)
Transport		(2,081,660)	(2,070,000)	(1,171,423)	(0.56%)
Economic Services		(44,754)	(44,500)	(135,260)	(0.57%)
Other Property and Services		119,791	1,185,020	(67,837)	89.89%
		<u>(2,728,858)</u>	<u>(1,639,880)</u>	<u>(2,153,784)</u>	
<b><u>Adjustments for Non-Cash</u></b>					
<b><u>(Revenue) and Expenditure</u></b>					
(Profit)/Loss on Asset Disposals		2,670	(1,992)	(1,992)	
Depreciation on Assets		665,578	665,578	648,095	
Movement in leave entitlements and accrued wages		(24,938)	(24,938)	-	
<b><u>Capital Revenue and (Expenditure)</u></b>					
Purchase Land Held for Resale		-	-	-	
Purchase Land and Buildings		(629,838)	(629,838)	(1,231,812)	
Purchase Infrastructure Assets - Roads & Footpaths		(662,257)	(662,257)	(735,417)	
Purchase Infrastructure Assets - Other		(107,199)	(107,199)		
Purchase Plant and Equipment		(417,874)	(417,874)	(164,092)	
Purchase Furniture and Equipment		-	-	(15,000)	
Proceeds from Disposal of Assets		29,442	29,442	37,439	
Repayment of Debentures		(32,896)	(32,896)	(41,275)	
Proceeds from New Debentures		-	-	-	
Transfers to Reserves (Restricted Assets)		(254,684)	(254,684)	(341,443)	
Transfers from Reserves (Restricted Assets)		241,597	241,597	240,000	
ADD Net Current Assets July 1 B/Fwd		889,851	889,851	889,851	
LESS Net Current Assets Year to Date		(538,728)	(1,812,549)	-	
<b>Amount Raised from Rates</b>		<u><b>(743,862)</b></u>	<u><b>(745,016)</b></u>	<u><b>(745,016)</b></u>	

This statement is to be read in conjunction with the accompanying notes.

SHIRE OF CUBALLING

NOTES TO AND FORMING PART OF THE STATEMENT OF FINANCIAL ACTIVITY

FOR THE PERIOD 1 JULY 2011 TO 30 APRIL 2012

	30-Apr	2012
3. ACQUISITION OF ASSETS	Actual	Budget
	\$	\$
The following assets have been acquired during the period under review:		
<b><u>By Program</u></b>		
Governance	7,893	7,893
Law Order Public Safety	319,682	
Housing	-	
Recreation and Culture	621,945	621,945
Transport	760,449	545,393
Other Property and Services	107,199	106,447
	<u>1,817,168</u>	<u>1,281,678</u>
<b><u>By Class</u></b>		
Land Held for Resale		
Land and Buildings	629,838	629,838
Infrastructure Assets - Roads & Footpaths	662,257	447,201
Infrastructure Assets - Other	107,199	106,447
Plant and Equipment	417,874	98,192
Furniture and Equipment	-	
	<u>1,817,168</u>	<u>1,281,678</u>

## SHIRE OF CUBALLING

## NOTES TO AND FORMING PART OF THE STATEMENT OF FINANCIAL ACTIVITY

FOR THE PERIOD 1 JULY 2011 TO 30 APRIL 2012

## 4. DISPOSALS OF ASSETS

<u>By Program</u>	Net Book Value	Sale Proceeds	Profit(Loss)
	30-Apr 2012 Actual \$	30-Apr 2012 Actual \$	30-Apr 2012 Actual \$
<b>Governance</b>			
Airconditioner	-	-	-
Fax Machine	-	-	-
ASI Pentium and NEC monitor	-	-	-
Canon Laser Printer	-	-	-
Octek Computer	-	-	-
Olivetti Typewriter	-	-	-
	-	-	-
<b>LOPS</b>	-	-	-
Fire Truck	-	-	-
<b>Housing</b>			
Lot 143 Bow Street	3,250.00	-	(3,250)
Lot 145 Bow street	3,250.00	-	(3,250)
Lot 147 Bow Street	3,250.00	-	(3,250)
<b>Recreation &amp; Culture</b>			
Stove Popo Hall	-	-	-
Gas stove and water Heater	10.00	-	(10)
	-	-	-
	-	-	-
<b>Transport</b>			
Toyota Hilux	-	3,637	3,637
Toyota Hilux	-	3,357	3,357
Holden VE Commodore Sedan	22,352	22,448	96
	22,352	29,442	(2,670)



SHIRE OF CUBALLING

NOTES TO AND FORMING PART OF THE STATEMENT OF FINANCIAL ACTIVITY

FOR THE PERIOD 1 JULY 2011 TO 30 APRIL 2012

4 DISPOSALS OF ASSETS

	Net Book Value	Sale Proceeds	Profit(Loss)
	30-Apr 2012 Actual \$	30-Apr 2012 Actual \$	30-Apr 2012 Actual \$
<b>Plant and Equipment</b>			
Toyota Hilux	-	3,637	3,637
Toyota Hilux	-	3,357	3,357
Holden VE Commodore Sedan	22,352	22,448	96
Fire Truck	-	-	-
<b>Furniture and Equipment</b>			
Airconditioner	-	-	-
Fax Machine	-	-	-
ASI Pentium and NEC monitor	-	-	-
Canon Laser Printer	-	-	-
Octek Computer	-	-	-
Olivetti Typewriter	-	-	-
Stove Popo Hall	-	-	-
Gas stove and water Heater	10	-	(10)
<b>Land and Buildings</b>			
Lot 143 Bow Street	3,250.00	-	(3,250)
Lot 145 Bow street	3,250.00	-	(3,250)
Lot 147 Bow Street	3,250.00	-	(3,250)
	32,112	29,442	(2,670)

**Summary**

Profit on Asset Disposals  
Loss on Asset Disposals

30-Apr 2012 Actual \$
7,090
(9,760)
(2,670)

**SHIRE OF CUBALLING**  
**NOTES TO AND FORMING PART OF THE STATEMENT OF FINANCIAL ACTIVITY**  
**FOR THE PERIOD 1 JULY 2011 TO 30 APRIL 2012**

**5. INFORMATION ON BORROWINGS**

(a) Debenture Repayments

Particulars	Principal 1-Jul-11	New Loans	Principal Repayments		Principal Outstanding		Interest Repayments	
			Actual \$	Budget \$	Actual \$	Budget \$	Actual \$	Budget \$
<b>Recreation &amp; Culture</b>								
Loan #60	9,774		9,702	9,774	72	-	383	218
Loan #61	39,943		6,230	8,561	39,943	31,382	1,747	2,074
<b>Transport</b>								
Loan #62	197,502		16,964	22,940	180,538	174,562	9,692	12,608
	247,219	-	32,896	41,275	220,553	205,944	11,822	14,900

All debenture repayments were financed by general purpose revenue.

(b) New Debentures

Council is not proposing to take out any new loans in the 2011-2012 financial year.

## SHIRE OF CUBALLING

## NOTES TO AND FORMING PART OF THE STATEMENT OF FINANCIAL ACTIVITY

FOR THE PERIOD 1 JULY 2011 TO 30 APRIL 2012

	30-Apr 2012 Actual \$	2011/12 Budget \$
<b>6. RESERVES</b>		
<b>Cash Backed Reserves</b>		
<b>(a) Plant and Equipment Reserve</b>		
Opening Balance	184,974	184,974
Amount Set Aside / Transfer to Reserve	4,445	24,551
Amount Used / Transfer from Reserve	-	-
	<u>189,419</u>	<u>209,525</u>
<b>(b) IT and Office Equipment Reserve</b>		
Opening Balance	8,438	8,438
Amount Set Aside / Transfer to Reserve	196	20,414
Amount Used / Transfer from Reserve	-	-
	<u>8,634</u>	<u>28,852</u>
<b>(c) Employee Entitlements</b>		
Opening Balance	24,992	24,992
Amount Set Aside / Transfer to Reserve	589	27,744
Amount Used / Transfer from Reserve	-	-
	<u>25,581</u>	<u>52,736</u>
<b>(d) Road and Bridge Construction Reserve</b>		
Opening Balance	241,597	241,597
Amount Set Aside / Transfer to Reserve	-	-
Amount Used / Transfer from Reserve	<u>(241,597)</u>	<u>(241,597)</u>
	-	-
<b>(e) Housing Reserve</b>		
Opening Balance	6,958	6,958
Amount Set Aside / Transfer to Reserve	169	414
Amount Used / Transfer from Reserve	-	-
	<u>7,127</u>	<u>7,372</u>
<b>(f) Recreation and Community Facility Res</b>		
Opening Balance	25,274	25,274
Amount Set Aside / Transfer to Reserve	246,415	251,924
Amount Transferred from Road and Bridge Res	1,597	241,597
Amount Used / Transfer from Reserve	-	<u>(240,000)</u>
	<u>273,286</u>	<u>278,795</u>
<b>(g) Refuse Site Reserve</b>		
Opening Balance	53,422	53,422
Amount Set Aside / Transfer to Reserve	1,273	12,760
Amount Used / Transfer from Reserve	-	-
	<u>54,695</u>	<u>66,182</u>
<b>Total Cash Backed Reserves</b>	<u>558,742</u>	<u>643,462</u>

All of the above reserve accounts are supported by money held in financial institutions.

SHIRE OF CUBALLING

NOTES TO AND FORMING PART OF THE STATEMENT OF FINANCIAL ACTIVITY

FOR THE PERIOD 1 JULY 2011 TO 30 APRIL 2012

6. RESERVES (Continued)	30-Apr 2012 Actual \$	2010/11 Budget \$
<b>Summary of Transfers To Cash Backed Reserves</b>		
<b>Transfers to Reserves</b>		
Plant and Equipment Reserve	4,445	24,551
IT and Office Equipment Reserve	196	20,414
Employee Entitlement Reserve	589	27,744
Road and Bridge Construction Reserve	-	-
Housing Reserve	169	414
Recreation and Community Facility Reserve	248,012	251,924
Refuse Site Reserve	1,273	12,760
	<u>254,684</u>	<u>337,807</u>
<b>Transfers from Reserves</b>		
Plant and Equipment Reserve	-	-
Office Equipment Reserve	-	-
Long Service Leave Reserve	-	-
Road and Bridge Construction Reserve	(241,597)	(241,597)
Housing Reserve	-	-
Recreation and Community Facility Reserve	-	(240,000)
Refuse Site Reserve	-	-
	<u>(241,597)</u>	<u>(481,597)</u>
<b>Total Transfer to/(from) Reserves</b>	<u>13,087</u>	<u>(143,790)</u>

In accordance with council resolutions in relation to each reserve account, the purpose for which the reserves are set aside are as follows:

Plant and Equipment Reserve

- to be used for the purchase and replacement of major items..

IT and Office Equipment Reserve

- to be used for the purchase of new and/or replacement of office equipment or furniture items.

Employee Entitlements

- to be used to fund employee entitlements

Road and Bridge Construction Reserve

- funds from this reserve have been reallocated to the Recreation and Community Facility Reserve

Housing Reserve

- to be used to fund the construction of new shire housing.

Recreation and Community Facility Reserve

- to be used to fund the upgrade of the oval and associated facilities.

Refuse Site Reserve

- to be used to fund the upgrade of the refuse site.

SHIRE OF CUBALLING

NOTES TO AND FORMING PART OF THE STATEMENT OF FINANCIAL ACTIVITY

FOR THE PERIOD 1 JULY 2011 TO 30 APRIL 2012

	30-Apr 2012 Actual \$	Brought Forward 1-Jul \$
<b>7. NET CURRENT ASSETS</b>		
<b>Composition of Estimated Net Current Asset Position</b>		
<b>CURRENT ASSETS</b>		
Cash - Unrestricted	507,890	317,451
Cash - Restricted	558,742	545,654
Prepaid assets	-	11,040
Receivables	60,009	1,109,308
Inventories	6,741	6,741
	<u>1,133,382</u>	<u>1,990,194</u>
<b>LESS: CURRENT LIABILITIES</b>		
Payables and Provisions	<u>(35,912)</u>	<u>(554,689)</u>
<b>NET CURRENT ASSET POSITION</b>	1,097,470	1,435,505
Less: Cash - Reserves - Restricted	(558,742)	(545,654)
<b>NET CURRENT ASSET POSITION</b>	<u>538,728</u>	<u>889,851</u>

**SHIRE OF CUBALLING**  
**NOTES TO AND FORMING PART OF THE STATEMENT OF FINANCIAL ACTIVITY**  
**FOR THE PERIOD 1 JULY 2011 TO 30 APRIL 2012**

**8. RATING INFORMATION**

<b>RATE TYPE</b>	<b>Rate in \$</b>	<b>Number of Properties</b>	<b>Rateable Value \$</b>	<b>2011/12 Rate Revenue \$</b>	<b>2011/2012 Interim Rates \$</b>	<b>2011-2012 Back Rates \$</b>	<b>2011/2012 Total Revenue \$</b>	<b>2011/12 Budget \$</b>
<b>General Rate</b>								
UV - Cuballing	0.005224	308	108,922,980	568,338	-	-	568,338	569,209
GRV - Cuballing	0.056434	188	2,044,220	106,468	-	-	106,468	106,597
<b>Sub-Totals</b>		496	110,967,200	674,806	-	-	674,806	675,806
<b>Minimum Rates</b>	<b>Minimum \$</b>							
UV - Cuballing	370.00	23	1,313,886	8,880	-	-	8,880	8,510
GRV Cuballing	425.00	142	56,451	59,778	-	-	59,778	60,350
<b>Sub-Totals</b>		165	1,370,337	68,658	-	-	68,658	68,860
Ex gratia rates Specified Area Rates							743,464 398	744,666 350
Discounts							743,862 (45,939)	745,016 (48,000)
<b>Totals</b>							697,923	697,016

All land except exempt land in the Shire of Cuballing is rated according to its Gross Rental Value (GRV) in townships or Unimproved Value (UV) in the remainder of the Shire.

The general rates detailed above for the 2008/09 financial year have been determined by Council on the basis of raising the revenue required to meet the deficiency between the total estimated expenditure proposed in the budget and the estimated revenue to be received from all sources other than rates and also bearing considering the extent of any increase in rating over the level adopted in the previous year.

The minimum rates have been determined by Council on the basis that all ratepayers must make a reasonable contribution to the cost of the Local Government services/facilities.

**SHIRE OF CUBALLING**

**NOTES TO AND FORMING PART OF THE STATEMENT OF FINANCIAL ACTIVITY**

**FOR THE PERIOD 1 JULY 2011 TO 30 APRIL 2012**

**9. TRUST FUNDS**

Funds held at balance date over which the Municipality has no control and which are not included in this statement are as follows:

Detail	Balance 1-Jul-10 \$	Amounts Received \$	Amounts Paid (\$)	Balance \$
Badminton Club	232	-	-	232
Commodine Tennis Club	3,490	-	(200)	3,290
Cuballing Fire Brigade	6,045	100	(2,442)	3,703
Recycling Children Fund	1,328	90	-	1,418
BCITF	0	-	-	-
Bonds - Building	14,339	-	(7,500)	6,839
Bonds - Hall Hire	900	400	(400)	900
Reimbursements	9,063	-	(99)	8,964
Social Club	4,030	2,988	(1,729)	5,289
Upper Hotham Project	15,027	-	-	15,027
Environment and Townscape Trust Fund	4,207	1,256	-	5,463
LCDC East Yornaning	1,360	-	-	1,360
Cuballing Country Festival	393	702	-	1,095
Prepayments	-	-	-	-
Cuballing Cricket Club	200	-	-	200
Cuballing Football Asson	2,567	-	-	2,567
Tax Payable	0	-	-	-
Swipe cards	415	-	-	415
Nomination Deposits	-	400	(400)	-
Cuballing Mens Shed	-	500	-	500
Cuballing Christmas Tree	-	393	-	393
	<u>63,596</u>			<u>57,655</u>

**10. SUPPLEMENTARY INFORMATION**

May include (not exhaustive) the following:

- Operating Statement;
- Balance Sheet;
- Debtors listings;
- Creditors listings;
- Cash/Investment summaries;
- Plant reports;
- Ratio analysis; and
- Other information considered relevant.

## 9.2.16 OPTION TO PURCHASE LOT 1 (75) ALTON ST CUBALLING

---

<b>Submission to:</b>	Ordinary Meeting of Council
<b>Location/Address:</b>	Vacant Land next to Cuballing Tavern, Lot 1 Alton Street, Cuballing
<b>Reporting Officer:</b>	Monique D'alton, Finance/Payroll Officer
<b>Enabling Legislation:</b>	Nil
<b>Council Policy:</b>	Nil
<b>Budget Implications:</b>	Nil
<b>File Reference:</b>	<b>Recreation 12</b>
<b>Voting Requirements:</b>	<b>Absolute Majority</b>

### **Background**

Lot 1 Alton Street Cuballing resides alongside the North Wall of Cuballing Tavern and extends from Alton through to Austral Street. Currently the Shire maintained Playground equipment resides there. The Cuballing Taverns' patrons utilise this recreation area.

### **Comment**

It was initially thought that where the playground equipment is situated, was recreation reserve. However, on investigation this is not the case. The recreation reserve is actually on the far right between Lot 1 and Lot 11 (refer Map). According to certificate of title the frontage on Lot 1 is 15.08 metres with the reserve being approximately 15 metres also. Currently there is 7-8 metres of the existing playground overlapping onto the reserve.

It is proposed that the Shire approach the Proprietors of the Cuballing Tavern with an offer to purchase the land. This would then remove responsibility from the Shire with regards to the play equipment and block maintenance and provide a small amount of revenue with the sale of the block and future rates.

### **OFFICER RECOMMENDATION:**

That the;

- 1. Shire of Cuballing take up the opportunity to sell Lot 1 Alton Street to the Proprietors of the Cuballing Tavern.**
- 2. Have an option to allow the Proprietors to payment plan, if required, over the period of designated years.**

**Moved:**

**Seconded:**



**COUNCIL DECISION:**

**That the Proprietors of Cuballing Hotel:**

- 1. Be offered Lot 1 Alton Street at the valuation provided by a licensed valuer in accordance with provisions of the Local Government Act 1995; and**
- 2. Repay the purchase price of Lot 1 Alton Street over a period of three years at no interest.**

**Moved: Cr Newman**

**Seconded: Cr Haslam**

***Carried by Absolute Majority: 6/0***

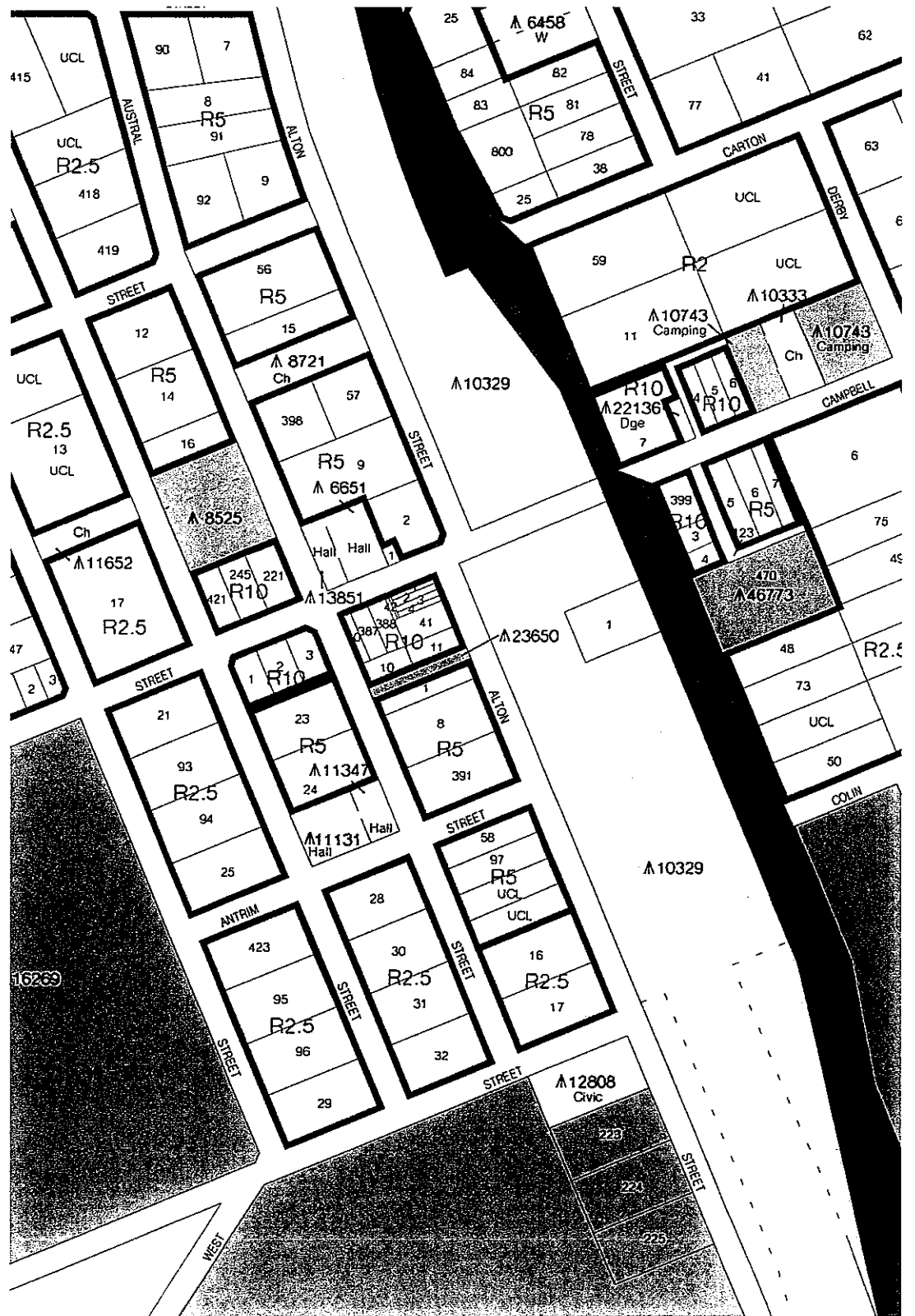

## 9.2.17 BAUXITE RESOURCES LIMITED

---

**Location/Address:** Whole of shire  
**Reporting Officer:** Leanne Shields – Rates Officer  
**Enabling Legislation:**  
**Council Policy:** Nil  
**Budget Implications:** Nil  
**File Reference:**  
**Voting Requirements:** N/A

### **Background**

Council has received an application for exploration licence 70/4342 as per attached map.

### **Officer's Comment**

Nil

<b>OFFICER RECOMMENDATION</b>
-------------------------------

<b>For Council information</b>
--------------------------------



**M & M Walter Consulting** 27 APR 2012

TENEMENT & NATIVE TITLE MANAGEMENT

Suite 1, 159 York Street  
Subiaco WA 6008  
PO Box 8197  
Subiaco East WA 6008  
Ph: (08) 9381 5866  
Fax: (08) 9381 5877  
Website: <http://mmwc.com.au>  
ABN 39 802 269 835

*Agenda  
Kenne.*

24 April 2012

**By Registered Post**

CEO  
Shire of Cuballing  
PO Box 13  
**CUBALLING WA 6311**

**COPY**

Dear Sir/Madam

**APPLICATION FOR EXPLORATION LICENCE 70/4342**

On behalf of our client, Bauxite Resources Ltd, we wish to advise they have made application for the abovementioned exploration licence. Details of the application are attached as follows:

- Copy of application; and
- A map showing area applied for.

Please do not hesitate to contact this office if you have any queries in regard to this application.

Yours faithfully

**Susan McKay**  
**Tenement Consultant**  
(For and on behalf of Bauxite Resources Ltd)

[sue@mmwc.com.au](mailto:sue@mmwc.com.au)

enc





Department of  
Mines and Petroleum



Map Grid of Australia, 1994 - Zone 50

TENGRAPH (c) 1992, 1993

02:03 PM, 17/04/2012

[Customized Screen] EX13230 PERTMXX8E

Geographical Data Australia  
WGS 1984 MGA 50 Zone 50  
Equity System V7.217.2  
500000mE

510000mE

520000mE

530000mE

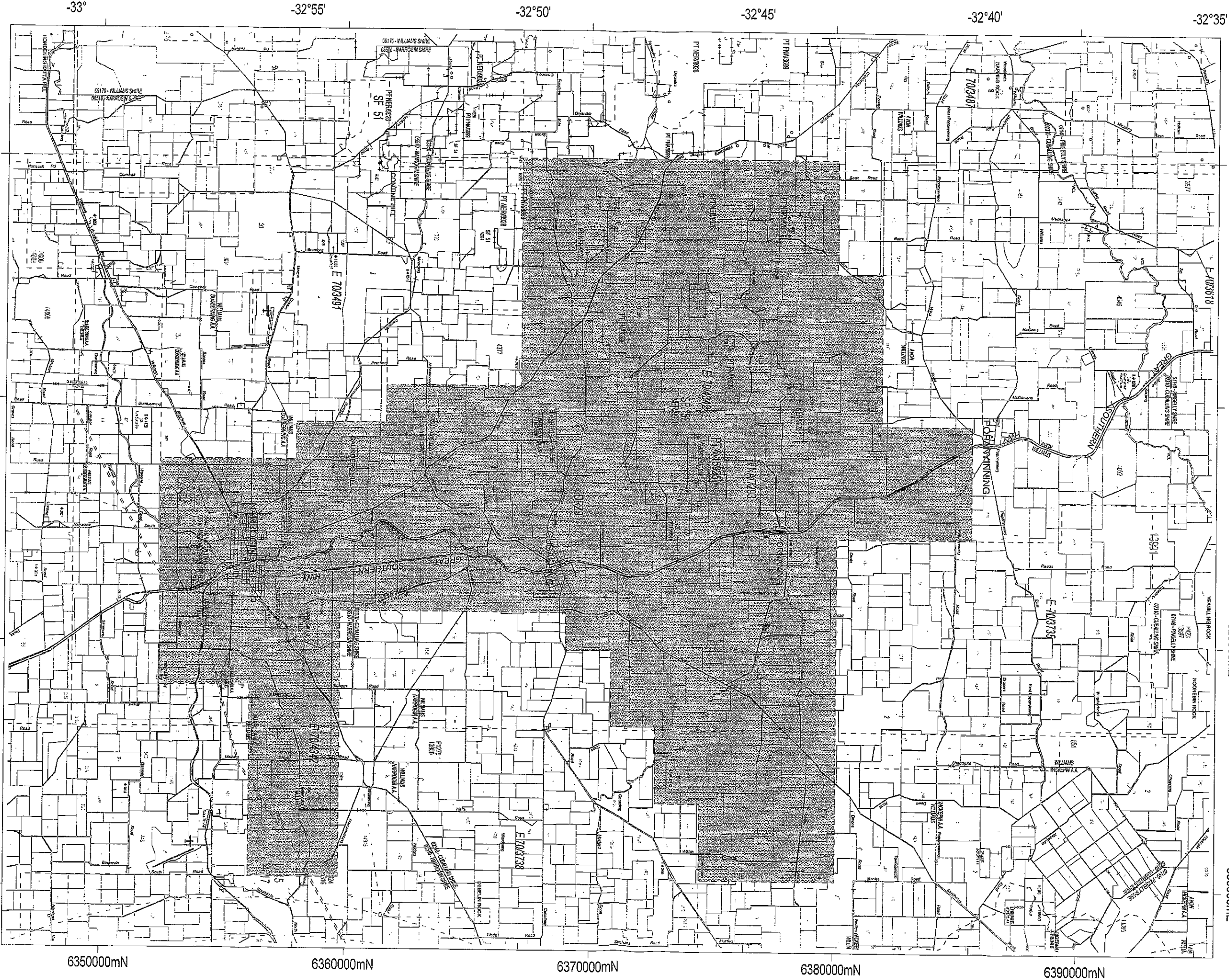

177°00' 177°05' 177°10' 177°15' 177°20'

-33° -32°55' -32°50' -32°45' -32°40' -32°35'

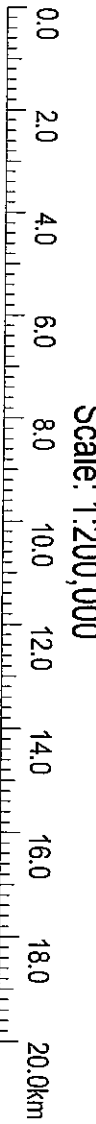

Scale: 1:200,000

This data has been compiled from various data sources...  
Copyright © 2002, Tengraph Australia and the Department of Mines and Petroleum.  
The copyright in this data is owned by Tengraph Australia. All rights reserved.  
This data is provided for your use only. It is not to be used for any other purpose.  
The Department of Mines and Petroleum is not responsible for any errors or omissions.  
The Department of Mines and Petroleum is not liable for any damages arising from the use of this data.  
The Department of Mines and Petroleum is not responsible for any loss of data or information.  
The Department of Mines and Petroleum is not responsible for any loss of time or money.  
The Department of Mines and Petroleum is not responsible for any loss of profit or income.  
The Department of Mines and Petroleum is not responsible for any loss of reputation or goodwill.  
The Department of Mines and Petroleum is not responsible for any loss of business or contracts.  
The Department of Mines and Petroleum is not responsible for any loss of data or information.  
The Department of Mines and Petroleum is not responsible for any loss of time or money.  
The Department of Mines and Petroleum is not responsible for any loss of profit or income.  
The Department of Mines and Petroleum is not responsible for any loss of reputation or goodwill.  
The Department of Mines and Petroleum is not responsible for any loss of business or contracts.

## 9.2.18 BOUNDARY CHANGE – WICKEPIN PINGELLY ROAD

<b>Location/Address:</b>	Whole of shire
<b>Reporting Officer:</b>	Eva Haydon – Chief Executive Officer
<b>Enabling Legislation:</b>	Local Government Act 1995as amended
<b>Council Policy:</b>	Nil
<b>Budget Implications:</b>	Nil
<b>File Reference:</b>	Roads
<b>Voting Requirements:</b>	<b>Absolute Majority</b>

### Background

Correspondence has been received from the Shire of Pingelly regarding a small section of Wickepin Pingelly Road (between Chopping and English Roads) which is located within the Shire of Cuballing, however the adjoining sections from the Pingelly townsite through to the eastern boundary of the Shire of Pingelly with the Shire of Wickepin, are within the Shire of Pingelly.

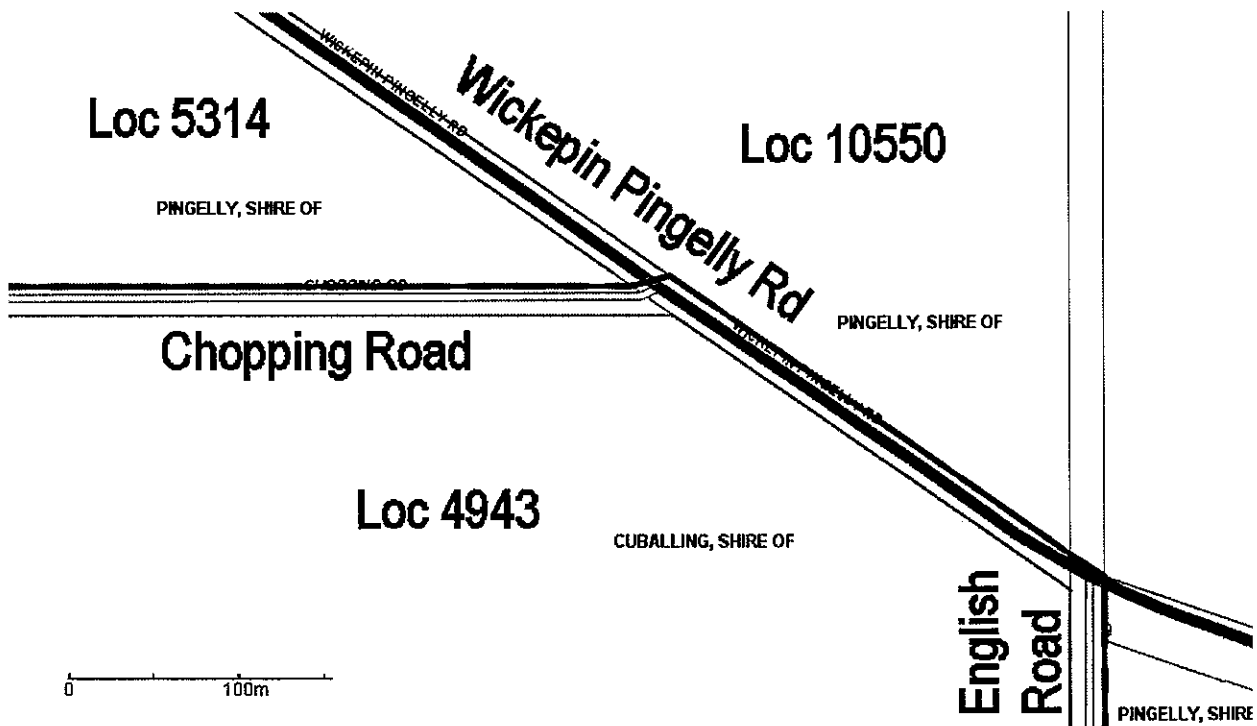

The Shire of Pingelly have considered this matter and resolved the following:

“That:

- The Shire of Cuballing’s agreement to support an amendment to the Shire boundary along the Wickepin Pingelly Road between Chopping Road and English Road be sought; and
- If agreement is received, formal application be made through the Department of Local Government for the Shire boundary to be amended.”

#### **Comment**

There is no disadvantage to the Shire of Cuballing should this matter be agreed to by Council and, as it would be deemed to be one of a minor nature and not one about which public submissions need to be invited, the WA Local Government Advisory Board would be likely to recommend that an order be made in accordance with the proposal.

#### **OFFICER RECOMMENDATION:**

**That the Shire of Pingelly be advised the Shire of Cuballing has no objection to the amendment to their boundary along the Wickepin Pingelly Road, between Chopping Road and English Road to enable that section of Wickepin Pingelly Road is wholly within the Shire of Pingelly.**

**Moved: Cr Conley**

**Seconded: Cr Hawksley**

***Carried by Absolute Majority: 6/0***



## **9.2.19 APPOINTMENT OF DUAL FIRE CONTROL OFFICERS 2012/2013**

---

**Location/Address:** Whole of shire  
**Reporting Officer:** Eva Haydon – Chief Executive Officer  
**Enabling Legislation:** Local Government Act 1995as amended  
**Council Policy:** Nil  
**Budget Implications:** Nil  
**File Reference:** Bushfire 5  
**Voting Requirements:** **Absolute Majority**

### **Background**

The Shire of Pingelly has written to seek the reappointment of dual fire control officers for 2012/2013.

### **Comment**

This has been a common practice in previous years.

### **Council Decision:**

**That the following be appointed Dual Fire Control Officers for the Shires of Cuballing and Pingelly:**

**Rodney Leonard Shaddick  
Neville Gordon Giles  
Alan William Parsons  
Anthony Turton  
Robert Alexander Kirk  
Andrew Augustin Marshall**

**Moved: Cr McDougall**

**Seconded: Cr Newman**

***Absolute Majority 6/0***

***Carried by***

## 9.2.20 REPRESENTATION ISSUES

---

**Location/Address:** Whole of shire  
**Reporting Officer:** Eva Haydon – Chief Executive Officer  
**Enabling Legislation:** Local Government Act 1995as amended  
**Council Policy:**  
**Budget Implications:**  
**File Reference:**  
**Voting Requirements:** Absolute Majority

### Background

Council resolved the following at the October 2011 meeting:

### **11.1.3 RTG POTENTIAL NUMBER OF COUNCILLORS**

---

**Location/Address:** Whole of shire  
**Reporting Officer:** Eva Haydon – Chief Executive Officer  
  
**Enabling Legislation:** Local Government Act 1995 as amended  
**Council Policy:** Nil  
**Budget Implications:** Nil  
**File Reference:** Structural Reform  
**Voting Requirements:** Simple Majority

### Background

*Discussions on the Amalgamated state document process resulted in confusion regarding the number of Councillors proposed for a possible amalgamated local government.*

*Some Councillors believed it was eight and others nine. Action required from the board meeting was a decision by individual councils to clarify a preference for eight or nine Councillors in a potential amalgamated local government.*

### Comment

*Nil*

- |  |
|--|
| <p><b>1. Shire of Cuballing preference is for eight councillors in a potentially amalgamated authority and</b></p> <p><b>2. The President be elected by the potentially amalgamated Council</b></p> <p><b>Moved: Cr Meharry                      Seconded: Cr Conley</b></p> <p><b>Carried      by      Absolute</b></p> <p><b>Majority 6/1</b></p> <p><b>Cr Hawksley voted against the motion</b></p> |
|--|

## **Comment**

This issue has been discussed at great length at RTG Board meetings, however it appears that not all Councillors are clear on the final items to be included in Governor's Orders, should a new local government be proclaimed.

### **OFFICER RECOMMENDATION**

For Council consideration

### **COUNCIL DECISION:**

1. Shire of Cuballing preference is for 7 councillors in a amalgamated authority and
2. The president be elected by the amalgamated Council
3. That in addition to government orders, for the first four years of the newly amalgamated local Government, there be two elected members from each of the former shires and three from the former town with no wards, in order that all electors in the newly amalgamated local government have the opportunity to elect Councillors.
4. Following the expiration of four years there be no wards in the new local government.

Moved: Cr Hawksley

Seconded: Cr Conley

***Carried 4/2***

***Crs Newman and McDougall voted against the motion.***

## 9.2.21 WALGA ANNUAL GENERAL MEETING 2012

---

**Location/Address:** Whole of shire  
**Reporting Officer:** Eva Haydon – Chief Executive Officer  
**Enabling Legislation:** Local Government Act 1995as amended  
**Council Policy:** Nil  
**Budget Implications:** Nil  
**File Reference:**  
**Voting Requirements:** **Simple Majority**

### **Background**

WALGA has circulated the Notice of Annual General Meeting to be held at the Perth Convention and Exhibition Centre on Wednesday 1 August 2012.

The deadline for agenda items is Monday 4 June 2012.

A request has also been received to register voting delegates. In previous years, the delegates have been the President and Deputy President.

### **Comment**

Nil

### **OFFICER RECOMMENDATION:**

**That the Shire of Cuballing voting delegates be Cr Tom Wittwer and Cr Roger Newman.**

**Moved**

**Seconded**

### **COUNCIL DECISION:**

**That the Shire of Cuballing voting delegates be Cr Tom Wittwer and Cr Tim Haslam.**

**Moved: Cr McDougall**

**Seconded: Cr Conley**

***Carried 6/0***



## **WORKS MANAGERS REPORT 9<sup>th</sup> May 2012**

### **WINTER GRADING**

Maintenance grading (winter) has commenced.  
One grader has started whole of the Shire winter maintenance grading using a multi roller for stabilisation on a rotational basis.

### **STORM DAMAGE**

All Storm Damage cleanups have been completed.  
Nearly every road within the Shire has been attended to. If any residual cleanup is required the works crews will handle it as a part of normal activities.

### **STANDPIPE CONTROLLERS**

The standpipe controllers continue to work as expected and have given no issues whatsoever for the last few months. Winter days with the shorter sunlight exposure will determine whether they are now fully satisfactory.

### **TREE MULCHING**

Tree pruning and clearing works have been undertaken within the Cuballing Townsite. Drain line clearing has been completed along Smith St, Clifford St, Knight St, Austral Street and Bow Street. In addition some light clearing has been undertaken along Russell St and Cuballing Street.

We have also cleared storm damage from Merwanga road, Some tree pruning was undertaken.

### **REFUSE SITES**

Fill materials have been carted to allow for the covering of both the Cuballing and Popanyinning refuse sites.

## **TREE SPRAYING**

Tree spraying has been undertaken along the bitumen road verges. This spraying does not include tree spraying within the town sites.

## **PLANT AND EQUIPMENT**

All items of plant and equipment are being serviced and maintained as required, and generally in good working order. A 10 year Plant Replacement program is currently being formulated. It may not be possible to complete this for the current Council Meeting. Current thought on the ten year plant replacement program is to work with our current status and not assume that amalgamation is a sure thing.

## **STAFF**

Tim Bradford resumed work after annual leave on the 30<sup>th</sup> April.  
Bob Walker returned earlier than expected and resumed on May 2<sup>nd</sup>  
Ewin Western is to commence leave on May 28<sup>th</sup> and returns on 9<sup>th</sup> July.

## **PRIVATE WORKS**

Minor gravel and sand cartage has been performed as required.

## **GRAIN FREIGHT ROUTE**

I am not aware of any additional progress from Main Roads in relation to the Grain Freight Route, nor have received anything further on the proposed intersection works.

.....

Bob Walker

Works Manager.

### 9.3.9 10 YEAR ROAD PROGRAM

---

**Location/Address:** Whole of shire  
**Reporting Officer:** Bob Walker – Works Manager  
**Enabling Legislation:**  
**Council Policy:** Nil  
**Budget Implications:**  
**File Reference:**  
**Voting Requirements:**

#### **Background**

It is a requirement that each LGA develop a 10 year strategic plan.

#### **Comment**

Towards meeting that requirement a 10 year road construction plan has been compiled. Whilst this document is only presented to council for information purposes at this time, it will need to be altered and or modified to suit Councils and its ratepayer's requirements.

Funding constraints are and will always be an issue on what can be achieved now and into the future.

This document will need to be presented to Council for consideration at its 2012-2013 budget meeting

#### **OFFICER RECOMMENDATION:**

**For Councillor information only at this time.**

**Moved**

**Seconded**







### 9.3.10 LETTER OF COMPLAINT

---

**Location/Address:** Whole of shire  
**Reporting Officer:** Bob Walker – Works Manager  
**Enabling Legislation:**  
**Council Policy:** Nil  
**Budget Implications:**  
**File Reference:**  
**Voting Requirements:** Simple Majority  
**Attachments:** Letter from Mr Lester Green, Works Managers Reply

#### **Background**

Drain cleaning and sight line, and under power line tree removal improvements had been scheduled to be undertaken where considered necessary throughout the Cuballing Townsite. Works had been completed on Rose St, Smith St, Clifford St, Russell St and a few other streets on the Eastern side of the town. The Works crew then moved to Bow St and then onto Austral Street.

#### **Comment**

Being aware that Mr Lester Green may object to any pruning, tree removal or drain clearing Bruce Brennan and I decided that we would let Lester know the intentions of the works.

After discussions regarding the required works Mr Green appeared to accept that the works were going to happen regardless. We did agree in fact to minimise the extent of the works we wished to undertake. This may require an additional attendance in the next couple of years to undertake further improvements.

Mr Green then requested me to undertake the complete garden removal at the Corner of Austral and Campbell Streets.

Subsequently Mr Green has written a letter of Complaint and I attach a copy for Councils information.

**Please note that Mr Green's letter is dated APRIL. All of the events leading to the letter being received occurred in MAY**

#### **OFFICER RECOMMENDATION:**

**For Council information only.**

**Moved**

**Seconded**

Eva Haydon

April 4<sup>th</sup> 2012.

CEO  
Cuballing Shire.

Eva

As per our conversation on Wednesday 2<sup>nd</sup> April.

My complaint is regarding road visibility at the corner of Austral and Campbell Streets.

The garden on the corner by the Shire office is obstructing vision to the left hand side of the road, for all vehicles, ( buses, trucks, machines, cars, cyclists) facing north in Austral Street.

Obstructions of this nature are not tolerated else where in the Shire.  
This is a safety issue.  
Especially as it is also a school bus stop.

Apply the same standards of visibility as at the corner of Darcy and Austral Streets  
And remove the obstruction!  
Before someone/ anyone gets injured.

Lester Green

A handwritten signature in cursive script that reads "Lester Green". The signature is written in dark ink and is positioned below the typed name.

**9.4.6 POPANYINNING GENERAL STORE –  
APPLICATION TO ADD AN ALFRESCO AND COVERING TO EXISTING  
APPROVED FAST FOOD OUTLET**

---

**Submission to:** Ordinary Meeting of Council  
**Location/Address:** Lot 9 Francis Street, Popanyinning  
**Reporting Officer:** Allan Ramsay, Environmental Health Officer/Building Surveyor  
**Enabling Legislation:** Planning and Development Act 2005  
**Council Policy:** Shire of Cuballing Town Planning Scheme No 2  
**Budget Implications:** Nil  
**File Reference:** TP 4  
**Voting Requirements:** Simple majority

**Background**

Correspondence has been received from the owners of the Popanyinning General Store (S & J Maughan) seeking planning approval to add an alfresco and covering to the approved fast food outlet (caravan) on the above lot which neighbours the Popanyinning General Store.

**Comment**

Council approved the use of the caravan as a fast food outlet at its meeting on the 15th March 2007. The food van is placed about 7 metres from the property boundary bordering onto Francis Street. The 9000mm×9000mm alfresco/shelter will be placed 1500mm from the front boundary as well as cover the food van for protection from the elements. In front of the food van it is proposed to have this area used as alfresco. Initially, the shelter will be open; however, Mr Maughan intends to have a plastic covering to the perimeter walls of the covering which can be rolled up.

A letter of support has been given from Mr Maughan's neighbour at Lot 10 Francis Street. Furthermore, Mr Maughan received overwhelming support from the community back in the year 2007 as part of the approval process for the fast food outlet.

Mr Maughan has contacted the Department of Minerals & Petroleum and they advised him that they had no concerns providing the alfresco/shelter was over 4000mm from the petrol bowsers.

**OFFICER RECOMMENDATION**

**That Council:**

**Approves the 9000mm×9000mm shelter with roll up plastic walls to be placed 1500mm from the front boundary and used for alfresco dining and covering to the fast food outlet at Lot 9 Francis Street, Popanyinning.**

**Building approval required prior to the construction of the Alfresco/Shelter.**

**Moved: Cr McDougall**

**Seconded: Cr Haslam**

***Carried 6/0***

## 9.4.7 **OUTBUILDING PROPOSAL LOT 331 CARTON STREET CUBALLING**

---

<b>Location/Address:</b>	Whole of shire
<b>Reporting Officer:</b>	Eva Haydon – Chief Executive Officer
<b>Enabling Legislation:</b>	Local Government Act 1995as amended
<b>Council Policy:</b>	<b>Town Planning Scheme No 2</b> <b>Section 5.10.2 (b)</b> <b>Local Planning Policy Outbuildings</b>
<b>Budget Implications:</b>	Nil
<b>File Reference:</b>	
<b>Voting Requirements:</b>	<b>Absolute Majority</b>

### **Background**

An building application for the construction of a 144 square metre shed has been received by the owner of Lot 331 Carton Street Cuballing. The proponent also intends to submit an application for a dwelling within the next few days.

### **Comment**

Council's Town Planning Scheme provides the following:

5.10.2 (b) Planning approval will not be granted for any outbuildings on any Rural Townsite or Rural Residential zoned lot which does not contain a residence.

This provision was included in the scheme to preserve the amenity of townsites.

Given that the proponent currently works on a mine site in Leinster, intends to construct a dwelling and the shed is required to store building materials during the construction of the dwelling, the author contacted Land Vision (Consultant Planners) to ascertain whether the outbuilding can be constructed. The advice obtained was that approval could be granted providing the dwelling was constructed within a reasonable timeframe, however without this condition, Council did not have discretionary power to vary the scheme provisions.

The other issue is the fact that planning approval is required due to the fact that the shed is oversized. The lot in question is 6000 square metres in size and Council has adopted a Local planning Policy relating to the size of outbuildings as follows:

In Rural Townsite and Rural Residential zones of the Shire where the lot size is over 1500 square meters or on General Agricultural zoned lots with and area of 2ha or less;

- (i) Zincalume construction where the total outbuilding does not exceed 85 square metres in total floor area;
- (ii) Colourbond construction where the total outbuilding does not exceed 120 square metres in total floor area; and
- (iii) Masonry construction and/or where the total outbuilding has walls constructed of the same materials and appearance as the house and does not exceed 170 square metres in total floor area.

- (iv) The proposed outbuilding is 20% larger than the maximum allowable to be constructed of colourbond and therefore does not comply with item (iii) of the local planning policy and will also require Council consideration.

**OFFICER RECOMMENDATION:**

**For Council consideration.**

**Moved**

**Seconded**

**This item has been deferred to the June meeting as the house plans are not available until next week.**

**10. ELECTED MEMBERS' MOTIONS OF WHICH PREVIOUS NOTICE HAS BEEN GIVEN**

**11. OTHER URGENT BUSINESS**

**12. NEXT MEETING**

Thursday 28 June 2012, 3.00pm

**13. CLOSURE OF MEETING**

There being no further business, the meeting closed at 5.05pm